

ABERNATHY and ASSOCIATES

Kenneth B. Abernathy Jr.

Wisconsin Registered Land Surveyor S-1594

Rt. 3, Box 273
Elkhorn, Wisconsin 53121
Phone: (414) 723-4260 (office)
(414) 723-4813 (residence)

PLAT OF SURVEY

LOT 14 OF BLOCK 2 OF BAY
VIEW MANOR SUBDIVISION
LOCATED IN SECTION 36,
TOWN 4 NORTH, RANGE 16
EAST, WALWORTH COUNTY,
WISCONSIN.

ORDERED BY: RE/MAX GENEVA REALTY, LTD.
C/O AL WITTENKELLER
101 BROAD ST. SUITE 102
LAKE GENEVA, WI. 53147-2060

OWNER: THEODORE DEVRIES TRUST
N7695 2nd AVE.
ELKHORN, WI. 53121

BLOCK

LOT 12

LOT 13

LOT 11

LOT 14
12,283 S.F.

SEPTIC VENT

EXISTING

RESIDENCE

WELL

STEWART DRIVE

50' WIDE

2ND AVENUE
50' WIDE

(N 88°35'E 101.00')

101.03'

90°50'10"

31.2'

88°39'50"

5.5'

40'

31.7'

29.1'

23.1'

49.7'

20.1'

29'

31.7'

122.93' (N 0°04'W 123.06')

(N 0°34'W 121.53')

121.57'

9.9'

overhead utilities along lot line

48°55'55"

99.95'

(S 89°26'W 99.94')

90°34'05"

POWER POLE
UTILITY PEDS

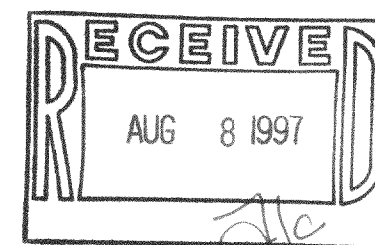

SCALE: 1"= 30 FEET

Legend

- ✕ FOUND IRON PIPE
- FOUND IRON ROD
- FOUND BRASS CAPPED MONUMENT
- ⊗ FOUND CONCRETE MONUMENT
- + CHISEL CUT IN CONCRETE
- SET IRON ROD, 24" LONG, WEIGHING 1.5 LBS./LINEAL FT., 3/4" DIA.
- SET IRON ROD, 30" LONG, WEIGHING 4.5 LBS./LINEAL FT., 1-11/16" DIA.
- (xx) RECORDED AS DIMENSION
- x-x- EXISTING FENCE

"I hereby certify that I have surveyed the above described property and that the above map is a true representation thereof and shows the size and location of the property, its exterior boundaries, the location of all visible structures and dimensions of all principal buildings thereon, boundary fences, apparent easements, roadways and visible encroachments, if any."

"This survey is made for the use of the present owners of the property, and also those who purchase, mortgage, or guarantee the title thereto within one year from date hereof."

Kenneth B. Abernathy Jr.

KENNETH B. ABERNATHY, JR.
WISCONSIN REGISTERED LAND SURVEYOR,

S-1594

Date: 7/23/97 Job No. 97.711

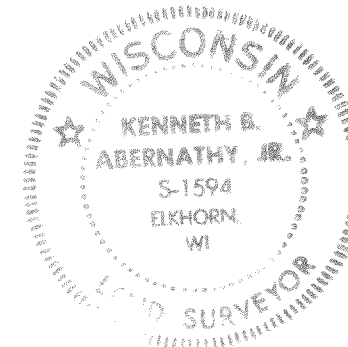

HB-39

416-1318